

# 30SP marine bulkhead

(B0-Rw 29 Db)

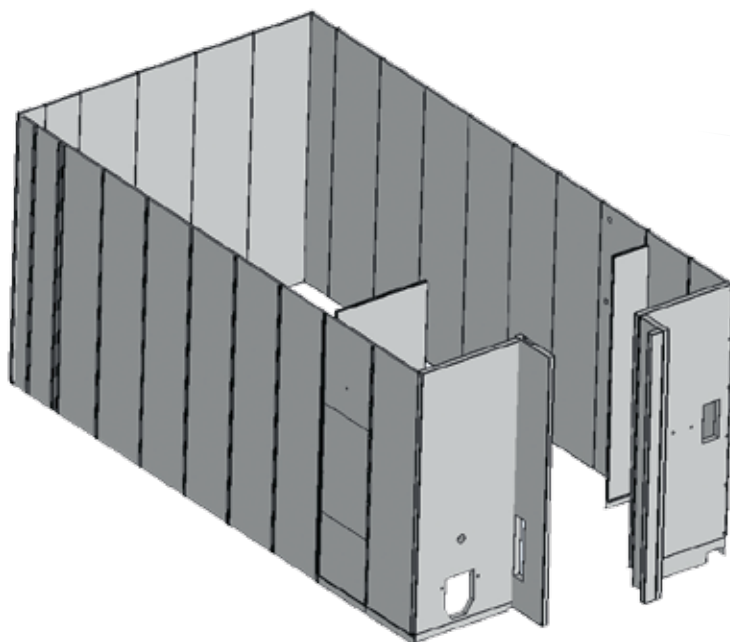

## Principales qualités. Main qualities

- Prix attractif. *Attractive price*
- Faible poids. *Lightweight*
- Profil d'assemblage intégré. *Integrated assembly profile*



## Applications



Family : 30 mm

### Bulkhead 30SP

Type : ..... simple skin  
 Coating : ..... 1 decorative side  
 Use : .. lining and prefabricated units  
 Thickness : ..... 30 mm  
 Fire classification : ..... B0  
 Noise reduction properties : .... 29Db  
 Junction profile : ..... integrated  
 Standard length : ..... 2200 mm  
 Standard width : ..... 500 mm  
 Weight : ..... 11.5 kg/m<sup>2</sup>



**MAPAC**

DESIGNER AND MANUFACTURER OF SANDWICH PANELS  
 FOR MARITIME AND SPECIAL BUILDING ACTIVITIES APPLICATIONS

Sté MAPAC Panel - 53 rue Marcel Brunelière - 44270 Machecoul - FRANCE - Tél. +33 (0)2 40 78 53 15  
 Fax +33 (0)2 40 31 42 16 - mapacpanel@mapac.fr

[www.mapac.fr](http://www.mapac.fr)

# Panneau marine de 30SP

(B0-Rw 29 Db)

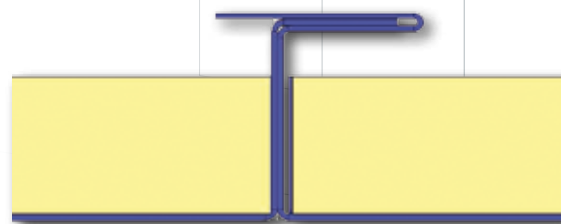

Jonction  
Junction

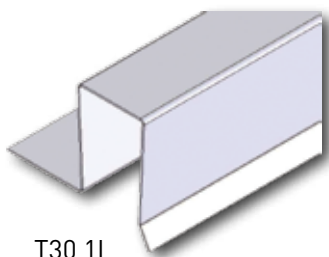

T30 1L

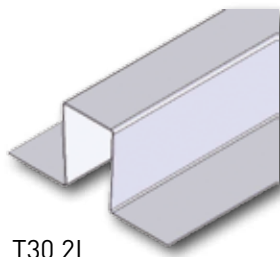

T30 2L

Exemples de profils de tête  
Head profile examples

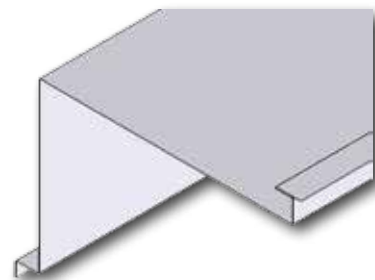

Panneau d'angle  
Angle panel

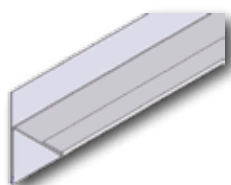

Profil départ Cloison PHC R  
Start profile partition PHC R

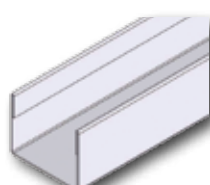

Profil d'extrémité PHU  
End profile PHU

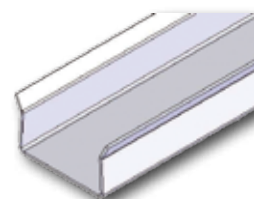

Profil de pied P30  
Foot profile P30

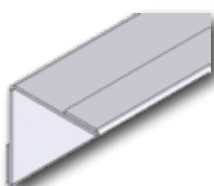

Profil d'habillage  
PHC  
Covering profile PHC

Famille : 30 mm

## Panneau 30SP

Composition : ..... simple peau  
 Finition : ..... 1 face décorative  
 Utilisation : ... vaigrage et ensemble préfabriqué  
 Epaisseur : ..... 30 mm  
 Classement feu : ..... B0  
 Acoustique Rw labo : ..... 29Db  
 Profil de jonction : . par emboîtement  
 Longueur standard : ..... 2200 mm  
 Largeur standard : ..... 500 mm  
 Poids : ..... 11.5 kg/m<sup>2</sup>



CONCEPTEUR ET FABRICANT DE PANNEAUX SANDWICH  
ADAPTÉS AUX ENVIRONNEMENTS MARITIMES ET TERRESTRES

Sté MAPAC Panel - 53 rue Marcel Brunelière - 44270 Machecoul - FRANCE - Tél. +33 (0)2 40 78 53 15  
 Fax +33 (0)2 40 31 42 16 - mapacpanel@mapac.fr

[www.mapac.fr](http://www.mapac.fr)