

# 50 mm acoustic marine bulkhead

(B15-Rw 42Db)

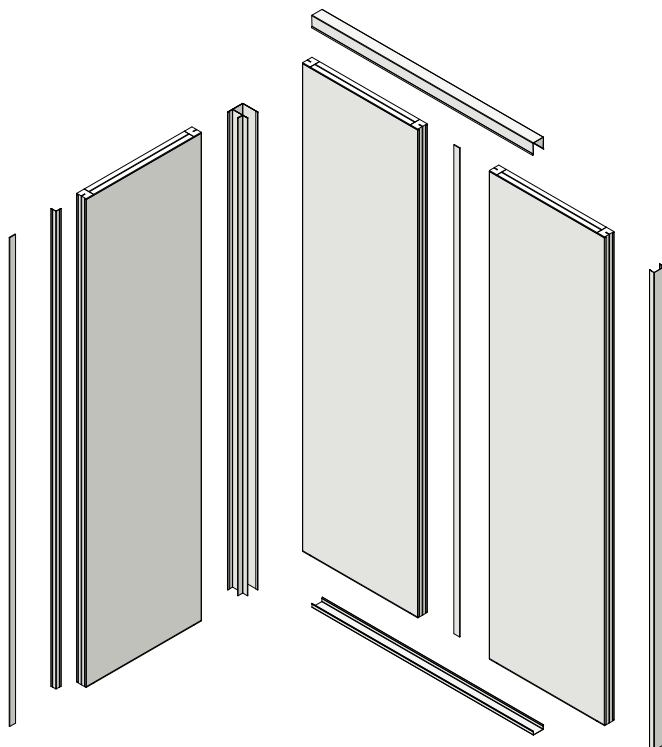

**Principales qualités. Main qualities**

- Très bonne atténuation acoustique.  
*High/top acoustic attenuation*
- Qualité de finition. *Top quality finish.*
- Possibilité de mélanger les décors.  
*Decors can be mixed.*

## Applications



## Family : 50 mm

### Bulkhead 50TAc

- Type : ..... double skin
- Coating : ..... 2 decorative sides
- Use : ..... lining and partition
- Thickness : ..... 50 mm
- Fire classification : ... B15
- Noise reduction properties : 42Db
- Junction profile : ... L50
- Standard length : ... 2200 mm
- Standard width : .... 600 mm
- Weight : ..... 21 kg/m<sup>2</sup>



DESIGNER AND MANUFACTURER OF SANDWICH PANELS  
FOR MARITIME AND SPECIAL BUILDING ACTIVITIES APPLICATIONS

MAPAC Panel - ZI La Seiglerie - 44270 Machecoul - FRANCE - Tél. +33 (0)2 40 78 53 15  
Fax +33 (0)2 40 31 42 16 - mapacpanel@mapac.fr

**www.mapac.fr**

# Panneau marine acoustique 50 mm

(B15-Rw 42Db)



Jonction. Panneau intégrant une lame d'air  
 Junction. Panel including an air strip

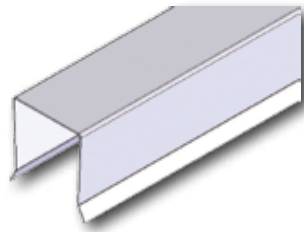
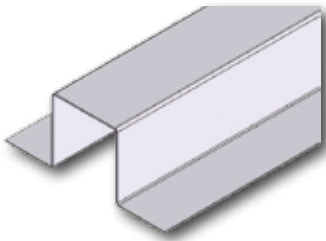

Exemples de profils de tête  
 Head profile examples

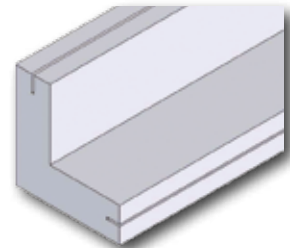

Panneau d'angle  
 Angle panel

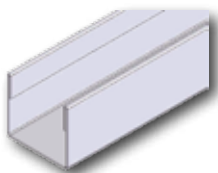

Profil d'extrémité PHU  
 End profile PHU

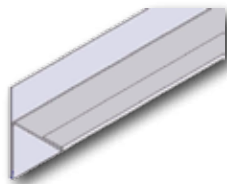

Profil départ Cloison PHC R  
 Start profile partition PHC R

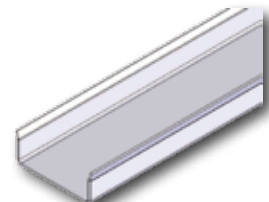

Profil de pied P50  
 Foot profile P50

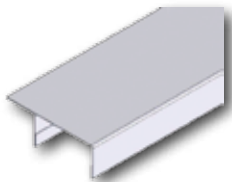

Profil départ cloison  
 Start profile partition

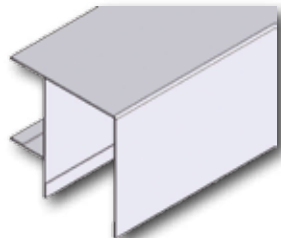

Profil d'angle T 50-50  
 Angle profile T50-50

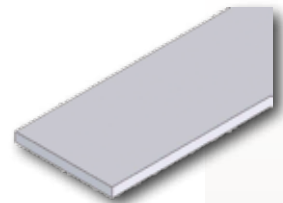

Clef d'assemblage 150  
 Junction profile 150

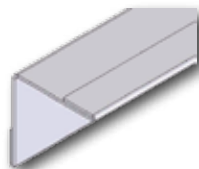

Profil d'habillage PHC  
 Covering profile PHC

## Famille : 50 mm

### Panneau 50TAc

Composition : ..... double peau  
 Finition : ..... 2 faces décoratives  
 Utilisation : ..... vaigrage et séparation  
 Epaisseur : ..... 50 mm  
 Classement feu : ..... B15  
 Acoustique Rw labo : . 42Db  
 Profil de jonction : ... L50  
 Longueur standard. ... 2200 mm  
 Largeur standard : ... 600 mm  
 Poids : ..... 21 kg/m<sup>2</sup>



CONCEPTEUR ET FABRICANT DE PANNEAUX SANDWICH  
 ADAPTÉS AUX ENVIRONNEMENTS MARITIMES ET TERRESTRES

S<sup>té</sup> MAPAC Panel - ZI La Seiglerie - 44270 Machecoul - FRANCE - Tél. +33 (0)2 40 78 53 15  
 Fax +33 (0)2 40 31 42 16 - mapacpanel@mapac.fr

[www.mapac.fr](http://www.mapac.fr)