

25 mm marine bulkhead

(B15-Rw 33 Db)

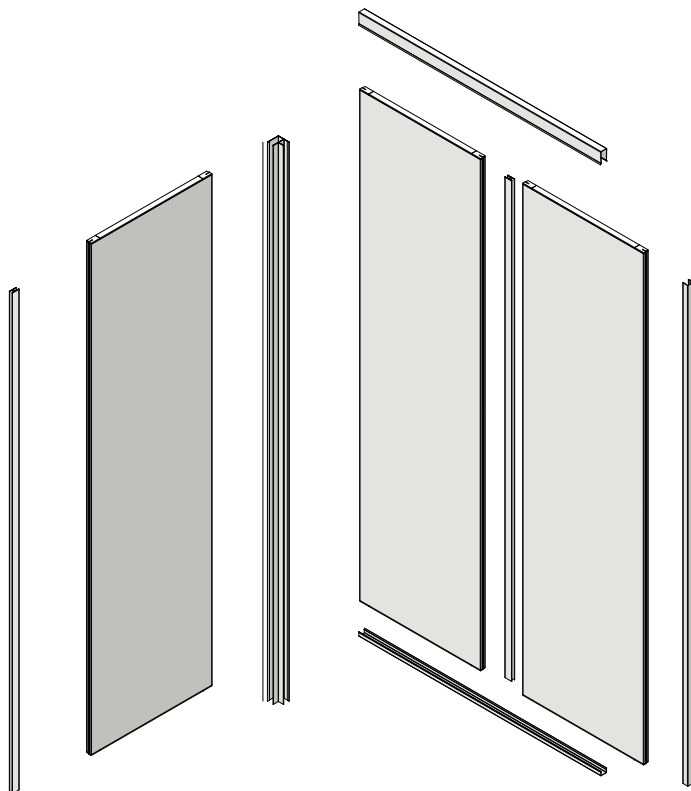

Principales qualités. Main qualities

- Forte rigidité. *High rigidity*
- Facilité d'assemblage. *Easy to assemble*
- Qualité de finition. *Top quality finish*
- Découpe possible du panneau. *Possibility to cut panel*

Applications



Family : 25 mm

Bulkhead 25T

Type : double skin
 Coating : 1 decorative side
 Use : ... lining and prefabricated units
 Thickness : 25 mm
 Fire classification : ... B15
 Noise reduction properties : 33Db
 Junction profile : H25
 Standard length : 2200 mm
 Standard width : 600 mm
 Weight : 14.5 kg/m²



DESIGNER AND MANUFACTURER OF SANDWICH PANELS
 FOR MARITIME AND SPECIAL BUILDING ACTIVITIES APPLICATIONS

MAPAC Panel - ZI La Seiglerie - 44270 Machecoul - FRANCE - Tél. +33 (0)2 40 78 53 15
 Fax +33 (0)2 40 31 42 16 - mapacpanel@mapac.fr

www.mapac.fr

Panneau marine de 25 mm

(B15-Rw 33 Db)

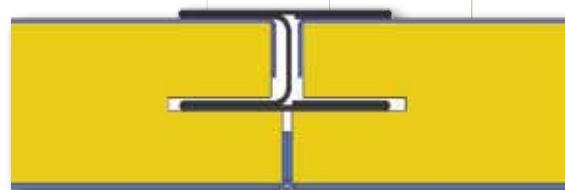
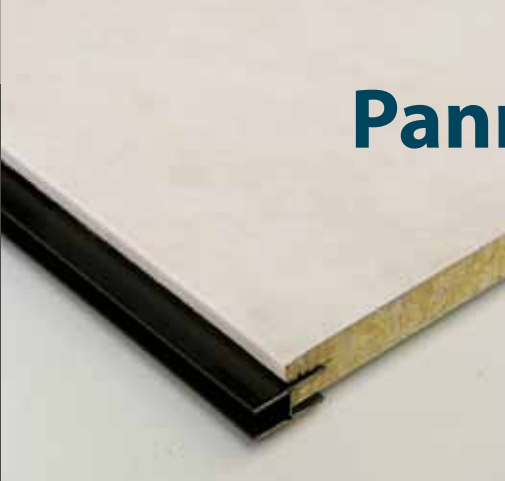

Jonction
Junction

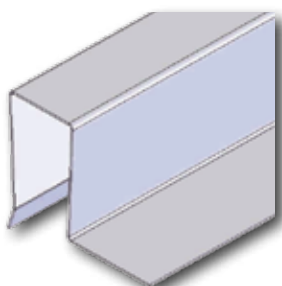

Profil de tête T25
Head profile T25

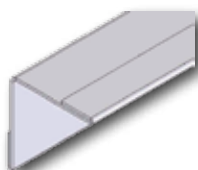

Profil d'habillage PHC
Covering profile PHC

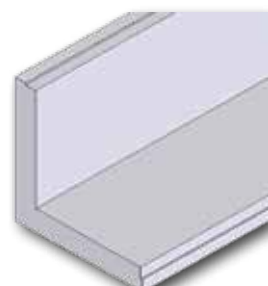

Panneau d'angle
Angle panel

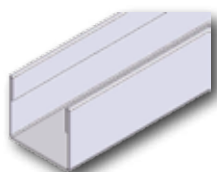

Profil d'extrémité PHU
End profile PHU

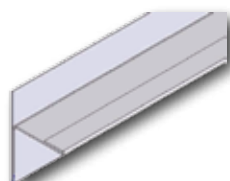

Profil départ Cloison PHC R
Start profile partition PHC R

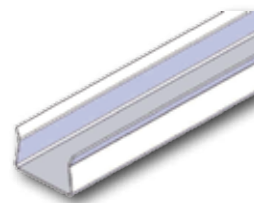

Profil de pied P25
Foot profile P25

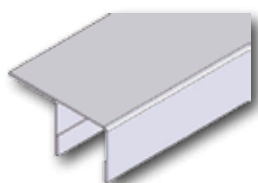

Profil départ cloison
Start profile partition

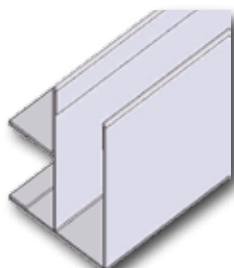

Profil d'angle T 25-25
Angle profile T25-25

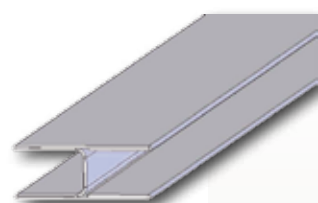

Clef d'assemblage H25
Junction profile H25

Famille : 25 mm

Panneau 25T

Composition : double peau
 Finition : 1 face décorative
 Utilisation : vaigrage et ensemble
 préfabriqué
 Epaisseur : 25 mm
 Classement feu : B15
 Acoustique Rw labo : . 33Db
 Profil de jonction : ... H25
 Longueur standard. . . 2200 mm
 Largeur standard : ... 600 mm
 Poids : 14.5 kg/m²



CONCEPTEUR ET FABRICANT DE PANNEAUX SANDWICH
 ADAPTÉS AUX ENVIRONNEMENTS MARITIMES ET TERRESTRES

S^{té} MAPAC Panel - ZI La Seiglerie - 44270 Machecoul - FRANCE - Tél. +33 (0)2 40 78 53 15

Fax +33 (0)2 40 31 42 16 - mapacpanel@mapac.fr

www.mapac.fr